



\*\*\*\*SOLD Lott family!!!\*\*\*\*



\*\*\*\*SOLD Lott family!!!\*\*\*\*

Model number: 37SSP16723AH19

**3 beds • 2 baths • 1152 sq.ft. • 16' width • 72' depth**

Our home building facilities invest in continuous product and process improvements. Plans, dimensions, features, materials, specifications and availability are subject to change without notice or obligation. Renderings and floor plans are representative likenesses of our homes and may differ from the actual homes. We invite you to tour a Home Center near you and inspect the highest value in quality housing available or call (270) 527-1451 to speak with a Home Consultant. Copyright 2017, CMH. All rights reserved.

<https://www.claytonhomesbenton.com>

**CLAYTON HOMES-  
BENTON**

1694 HIGHWAY 641 N  
BENTON, KY 42025

Monday - Thursday: 9am to 6pm  
Friday: 9am to 6pm  
Saturday: 9am to 5pm  
Sunday: Closed

(270) 527-1451



\*\*\*\*SOLD Lott family!!!\*\*\*\*

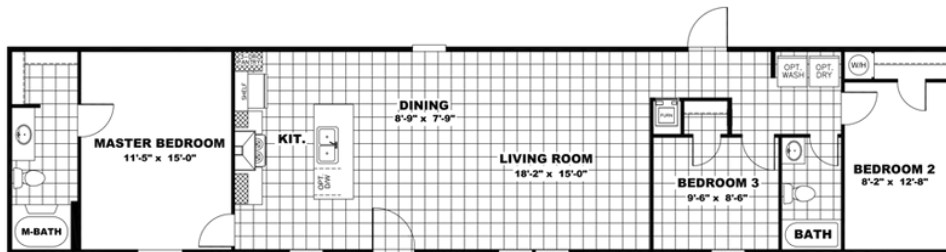

\*\*\*\*SOLD Lott family!!!\*\*\*\*

Model number: 37SSP16723AH19

3 beds • 2 baths • 1152 sq.ft. • 16' width • 72' depth

Our home building facilities invest in continuous product and process improvements. Plans, dimensions, features, materials, specifications and availability are subject to change without notice or obligation. Renderings and floor plans are representative likenesses of our homes and may differ from the actual homes. We invite you to tour a Home Center near you and inspect the highest value in quality housing available or call (270) 527-1451 to speak with a Home Consultant. Copyright 2017, CMH. All rights reserved.

<https://www.claytonhomesbenton.com>

CLAYTON HOMES-  
BENTON

1694 HIGHWAY 641 N  
BENTON, KY 42025

Monday - Thursday: 9am to 6pm  
Friday: 9am to 6pm  
Saturday: 9am to 5pm  
Sunday: Closed

(270) 527-1451